



250W SWITCHING POWER SUPPLY SINGLE OUTPUT SL-250 Series



■Applications

- .Industrial automation machinery
- .Industrial control system
- .Testing and measuring instruments
- .Household appliances
- .Led lighting appliances
- .Aging equipment
- .IT communication equipment

■Features

- Protection: short-circuit, overload
- 100% full-load aged
- Withstand 300VAC surge input for 5 seconds
- 20~+60°C Working temperature
- 5G vibration tested
- High efficiency, long life span, and high reliability
- LED indicator for power on
- 3 years warranty

Specifications

Product No.	SL-250-12	SL-250-24			
Output	DC voltage	12V	24V		
	Rated Current	20A	10A		
	Current Range	0-20A	0-10A		
	Rated Power	250W	250W		
	Ripple and Noise(Max)Note.2	150mVp-p	240mVp-p		
	Voltage adjustment	10.8-13.2V	22-27.6V		
	Voltage Accuracy Note3	±1%	±1%		
	Linear Adjustment Note4	±0.5%	±0.5%		
	Load Adjustment Note5	±0.5%	±0.5%		
	Start and rise time	1000ms,30ms/230VAC 1000ms,30ms/110V			
Hold time (Typ)	50ms/230VAC 10ms/115AC				
Input	Voltage range	176-264AC			
	Frequency range	50Hz/60Hz			
	Efficiency (Typ)	80%	82%		
	AC current (Typ)	4.7A/110V 2.3A/220V			
	Surge current (Typ)	Cold Start: 65A/230VAC			
	Current leak	<2mA/240VAC			
Protection	Overload	Larger than 105% of capacity Protection type : Hiccup mode, recovers automatically after fault condition is removed			
	Overvoltage	Protection type :Shut down O/P voltage,re-power on to recover			
	Overheat				
Environment	Working temp.	-20~+60°C (Refer to the tenuation curve)			
	Working humidity	20~90% RH, without condense			
	Storage temp & hmdty	-40~+80°C			
	Temp. coefficient	±0.03%/°C (0~50°C)			
	Vibration proof	10~500HZ,5G 10min / cycle, X、Y、Z axes 60 min each			
Safety reg. & EMC (Note.6)	Safety regulation	GB195110.1-2004/IEC61347-1:2003 CE(EMC+LVD)			
	Voltage proof	I/P-O:1.5KVAC I/P-FG:1.5KVAC O/P-FG:0.5KVAC			
	insulation resistance	I/P-O/P, I/P-FG,O/P-FG:100M Ohms/500VDC/25°C/70% RH			
	EMC irradiation	EN 55032A:2006;EN61000-3-2:1995+A2:2005			
	EMC disturbance proof	EN 61000-3-2:2006;			
	Dimensions	225x62x40mm(L*W*H)			
	Packing	0.55kg/PCS;30PCS/16.5kg			
Notes:	1. All parameters NOT specially mentioed are measured at 230VAC input, rated load and 25°C of ambient temperature. 2.Ripple and noise are measured at 20MHz bandwidth by using a 12" twisted pair-wire terminated with a 0.1μF and a 47 μF parallel capacitor. 3.Accuracy: including preset errors, linear adjustment rate and load adjustment rate. 4.Linear adjustment: taken under rated load from low voltage to high voltage. 5.Load adjustment: taken under 0~100% of rated load. 6. The power supply is taken as part of the whole system, and needs to be confirmed with final equipment for EMC.				

■ Mechanical Specification

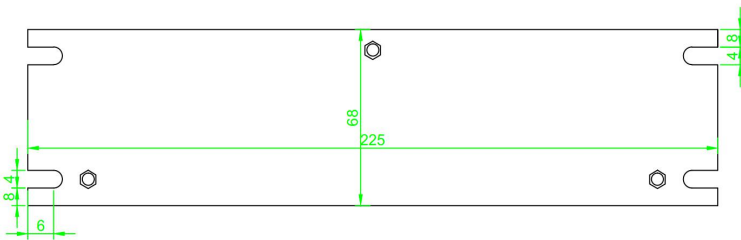
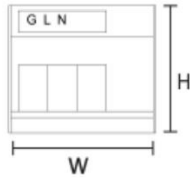
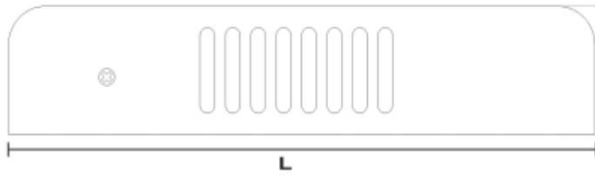

■ Block Diagram

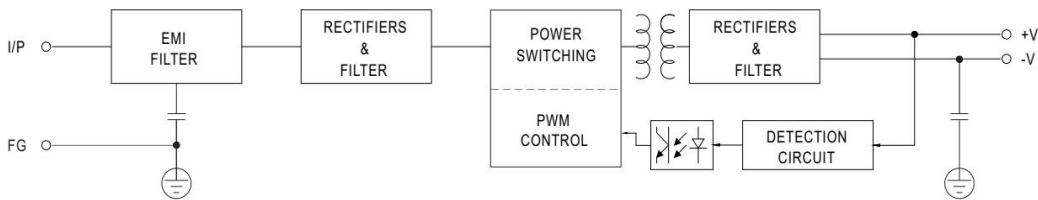

■ Derating Curve

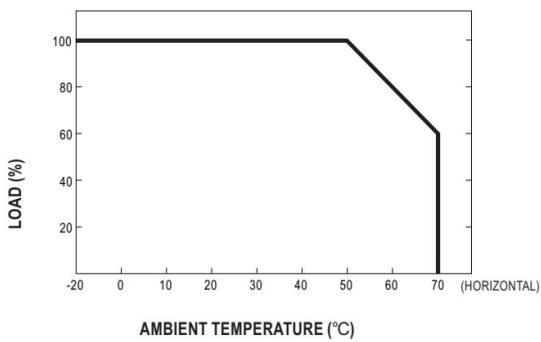

■ Output Derating VS Input Voltage

